

***ELITE A.G***  
**POCKET FUSING  
MACHINE**

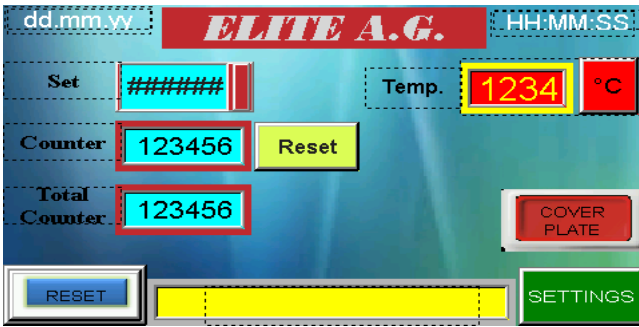

## MAIN PAGE

- **SET** : Enter working quantity.
- **COUNTER** : Already finished quantity. you can reset with RESET button.
- **TOTAL COUNTER** : This shows total working qty. from beginning. You can reset if you wish.
- **TEMP** : Show instant temperature
- **COVER PLATE** : Cover close manually.

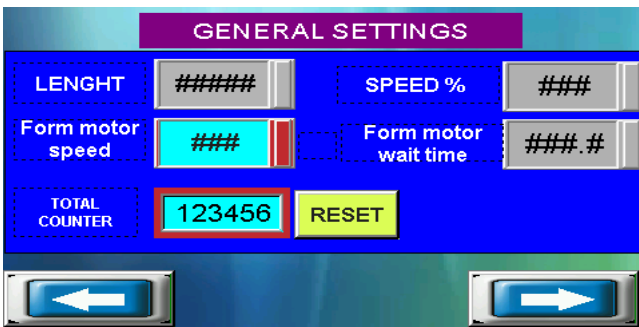

## GENERAL SETTINGS

- **LENGHT** : Adjust moving A molds ; moving area. (SCHEMA-3)
  - **SPEED** : Machine speed
  - **FORM MOTOR SPEED** : Adjust moving A molds ; moving speed. (SCHEMA-2)
  - **FORM MOTOR WAIT TIME** : Moving A molds waiting time at end position. (SCHEMA-1)
- P.S** : Its for transfer easier for folded fabric.

SCHEMA-1

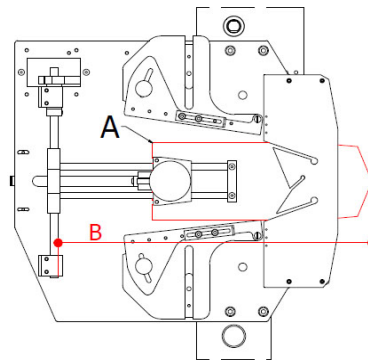

SCHEMA-2

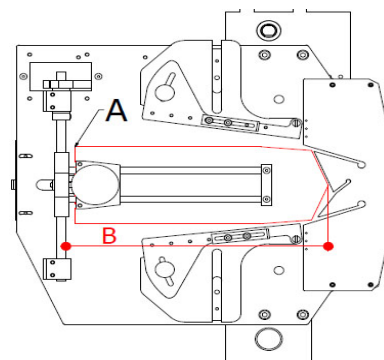

SCHEMA-3

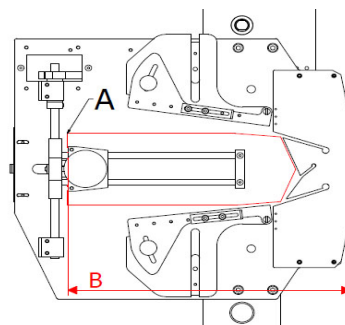

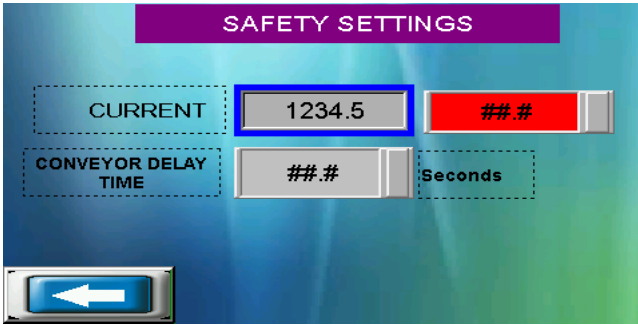

## SAFETY SETTINGS

- **CURRENT** : Fusing band security tension value  
Default 2-2.6.
- **CONVEYOR DELAY TIME** : 1-) Check jamming.  
2-) If jamming continue machine will stop in 6secs. automatically.

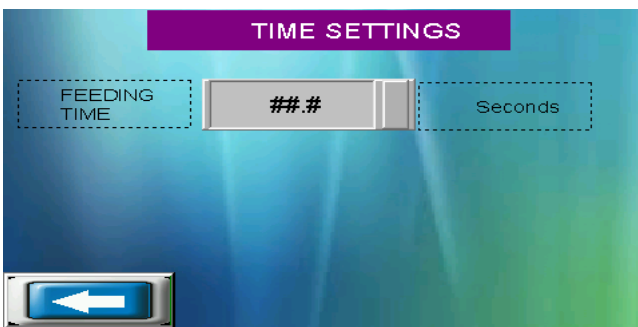

## TIME SETTINGS

- **FEEDING TIME** : A molds moving delay time after mold close.

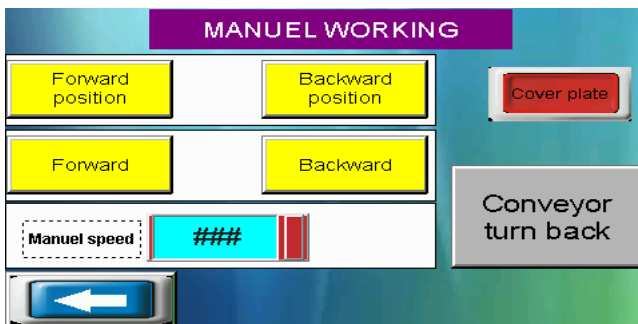
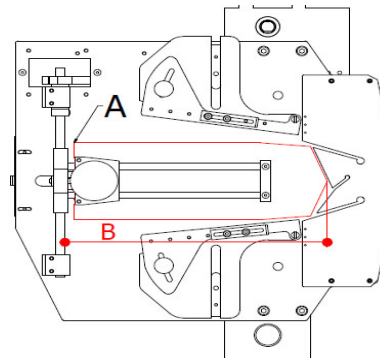

- **FORWARD POSITION** : Push mold forward automatically.
- **FORWARD** : Push mold forward manually.
- **BACKWARD POSITION** : Pull mold backward automatically.
- **BACKWARD** : Pull mold backward manually.
- **Conveyor Turn Back** : If any unwanted object get inside of bands machine will give jamming alarm. You can backwards bands and take off object.

## BAND REPLACEMENT

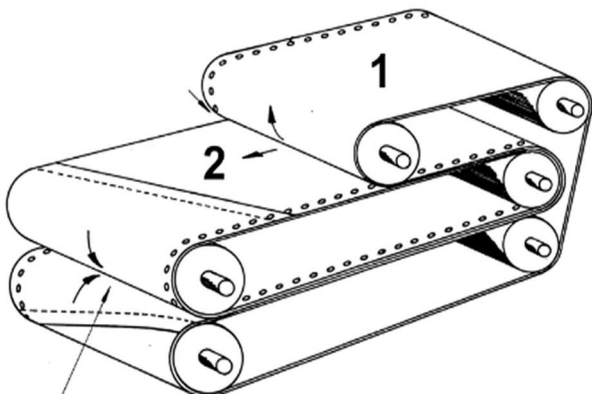
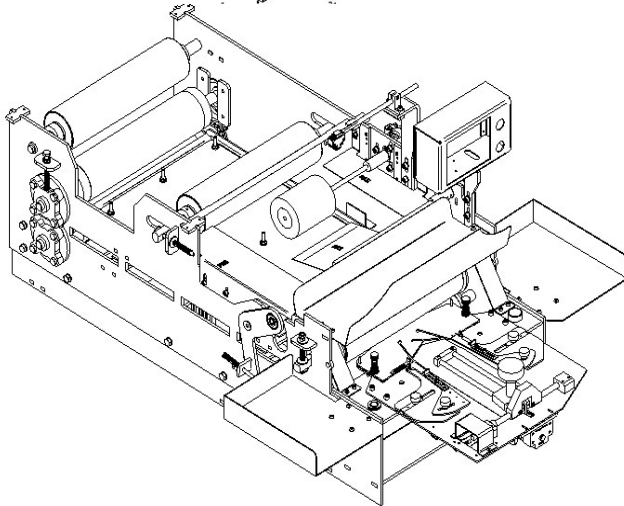
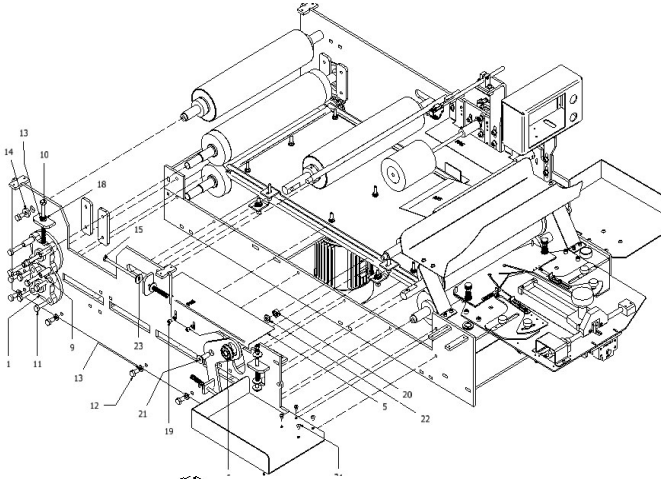

### BAND LENGHT

- 1-) 2375x320
- 2-) 1660x320

# SETUP

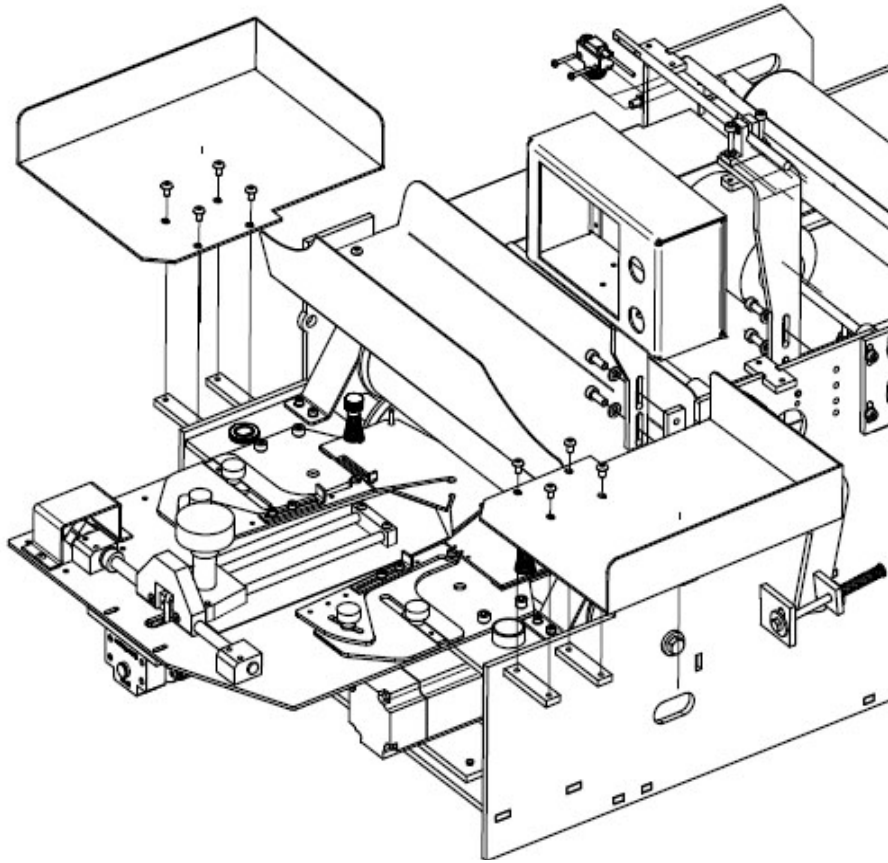

## DATA SHEET

ELITE A.G ; POCKET FUSING MACHINE

MODEL ; S61

SERIAL NUMBER ; O20S6104

MADE IN TURKEY

ENERGY ; 220 V AC

ENERGY CONSUMPTION ; 3750 WATT / PER HOUR

AIR ; 6 BAR / 85 PSI

AIR CONSUMPTION ; 10 LT. / PER MIN

TEMPERATURE ; 200 C = 392 F

# **PART LIST**

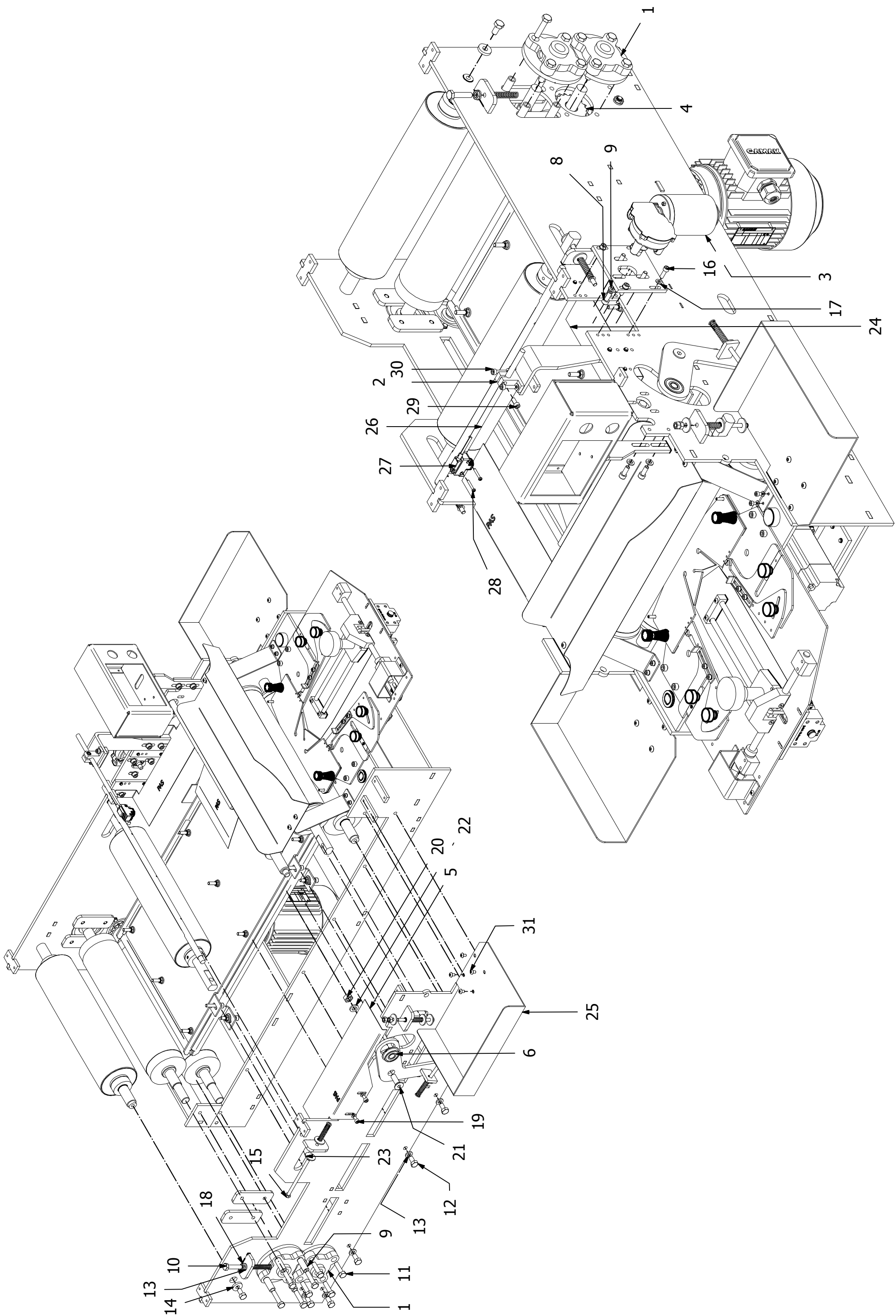



ITEM	QTY	DESCRIPTION	PART NUMBER
1	4	Flange FC204 Bearings UC203	s61f_18
2	1	SK 8 Shaft Holder	s61f_50
3	1	Wire Drive Feed 24V / 50W 200 RPM	s61f_32
4	3	DIN 8187 - ISO 606 roller chains	s61f_43
5	1		s61f_53
6	2	B6201ZZNR Ball Bearings	s61f_55
7	1	R7M_A40030 Servo	R7M_A40030_S1
8	15	Hexagon Socket Head Cap Screw ISO 4762 - M6 x 12ISO	S61F_101
9	16	Plain washers - Normal series - Product grade A ISO 7089 - 6 - 140 HV	S61F_102
10	10	Hexagon head screws ISO 4017 - M8 x 35 - ISO	S61F_104
11	8	Hexagon head screws. Product grade C ISO 4017 - M8 x 35 - ISO	S61F_105
12	12	Hexagon head screws. Product grade C ISO 4018 - M8 x 16	S61F_106
13	11	Plain washers for clevis pins - Product grade A ISO 8738 - 8	S61F_107
14	5	Plain washers for bolts with heavy clamping sleeves DIN 7349 - 8,4	S61F_108
15	4	Hexagon head screws. Product grade C ISO 4018 - M6 x 100	S61F_109
16	8	Hexagon Socket Head Cap Screw ISO 4762 - M5 x 16ISO	S61F_110
17	18	Plain washers for clevis pins - Product grade A ISO 8738 - 5	S61F_111
18	3	Hex Nut ISO 4035 - M8DIN EN	S61F_116
19	4	Hexagon Socket Head Cap Screw ISO 4762 - M5 x 10ISO	S61F_112
20	2	Hexagon nuts for structural bolting, style ISO 7413 - M10	S61F_123
21	2	Hexagon Socket Countersunk Head Screw-1 - Product grade A ISO 10642 - M10 x 30	S61F_124
22	2	Plain washers for clevis pins - Product grade A ISO 8738 - 10	S61F_125
23	14	Plain Washers - Extra large series - Product grade C ISO 7094 - ST 6 - 100 HV	S61F_126
24	1	Guard	s61f_54
25	1	Piling	s61f_06
26	1	Axle	S61F_132
27	1	Photoelectric Sensor	S61F_133
28	2	Pan head screw with type Z cross recess ISO 7045 - M3 x 20 - 4.8 - Z	
29	1	Hexagon Socket Head Cap Screw ISO 4762 - M5 x 12ISO	M5 x 12ISO
30	2	Hexagon Socket Head Cap Screw ISO 4762 - M5 x 20ISO	M5 x 20ISO
31	12	Hexagon Socket Button Head Screw ISO 7380-1 - M5 x 8	7380-1 - M5 x 8

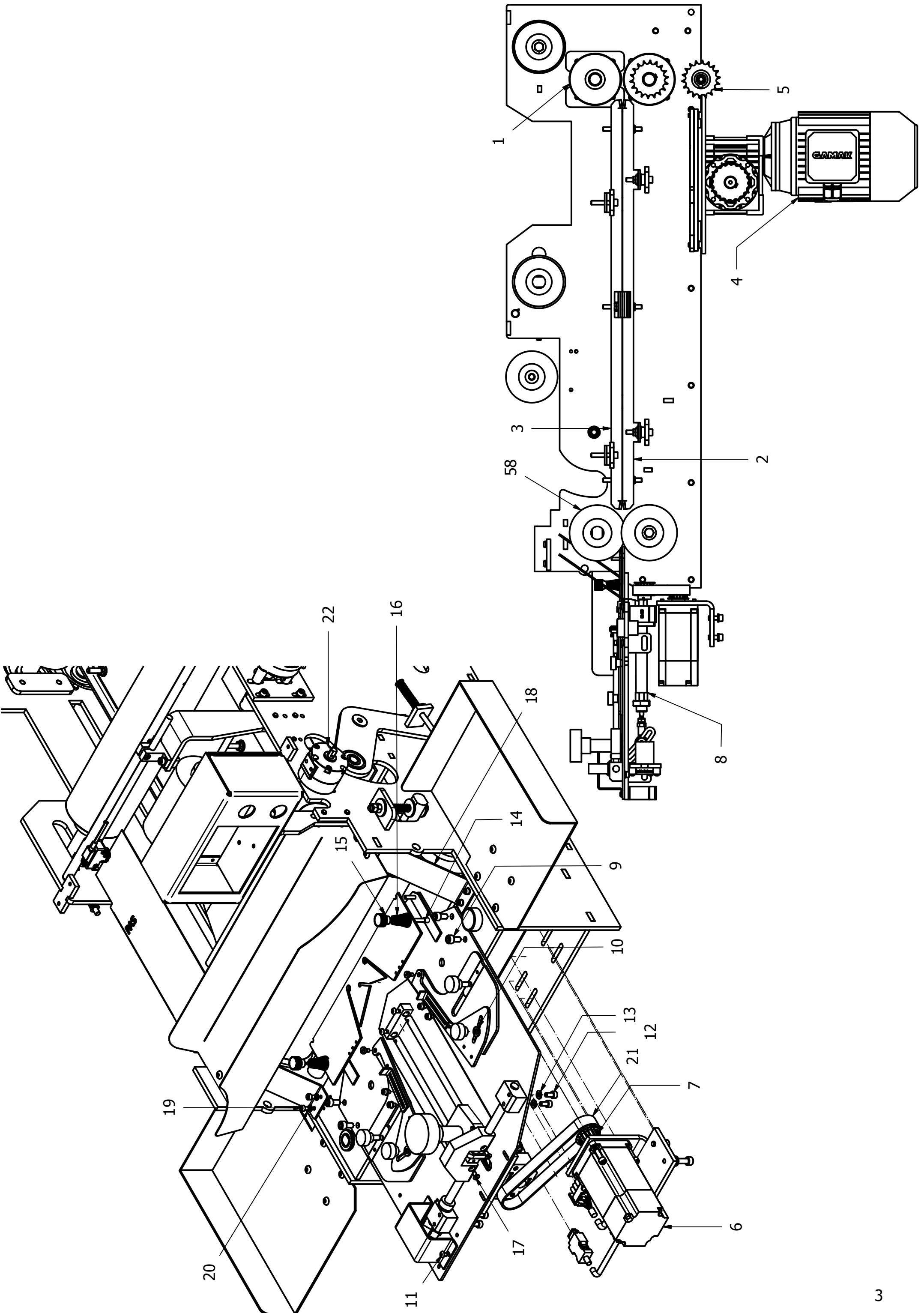

ITEM	QTY	DESCRIPTION	PART NUMBER
1	2	Roller	s61f_44
2	1	Heater Pan	s61f_34
3	1	Heater Pan : Top	s61f_35
4	1		Motor
5	3	Sprockets for roller chains DIN 8187 - ISO 606	s61f_43
6	1	R7M_A40030_S1 Servo	
7	1	92106 Servo Belt Pulley	S61F_161
8	1	Standard Air Cylinder:Standard Type Double Acting Single Rod 16-100	s61F_163
9	4	Hexagon Socket Head Cap Screw	ISO 4762 - M6 x 12
10	2	Plain washers - Normal series - Product grade A	ISO 7089 - 6 - 140 HV
11	4	Hexagon Socket Button Head Screw - Product grade A	ISO 7380-1 - M4 x 6
12	4	Hexagon Socket Head Cap Screw	ISO 4762 - M5 x 10
13	4	Plain washers for clevis pins - Product grade A	ISO 8738 - 5
14	2	Custom Bolts M6 - M4	S61F_1245
15	2	Set Screw	S61F_153
16	2	Spring	
17	2	Hexagon socket countersunk head cap screws	DIN 7991 - M4x8
18	2	Guard	s61F_162
19	4	Hexagon Socket Head Cap Screw	ISO 4762 - M4 x 6
20	4	Plain washers for clevis pins - Product grade A	ISO 8738 - 4
21	1	Belt	S61F_158
22	1	Rotary Cylinder	S61F_14